

LIBRA H7 DOWEL FIXING WITH ALUMINIUM BAR LIVING SETTINGS

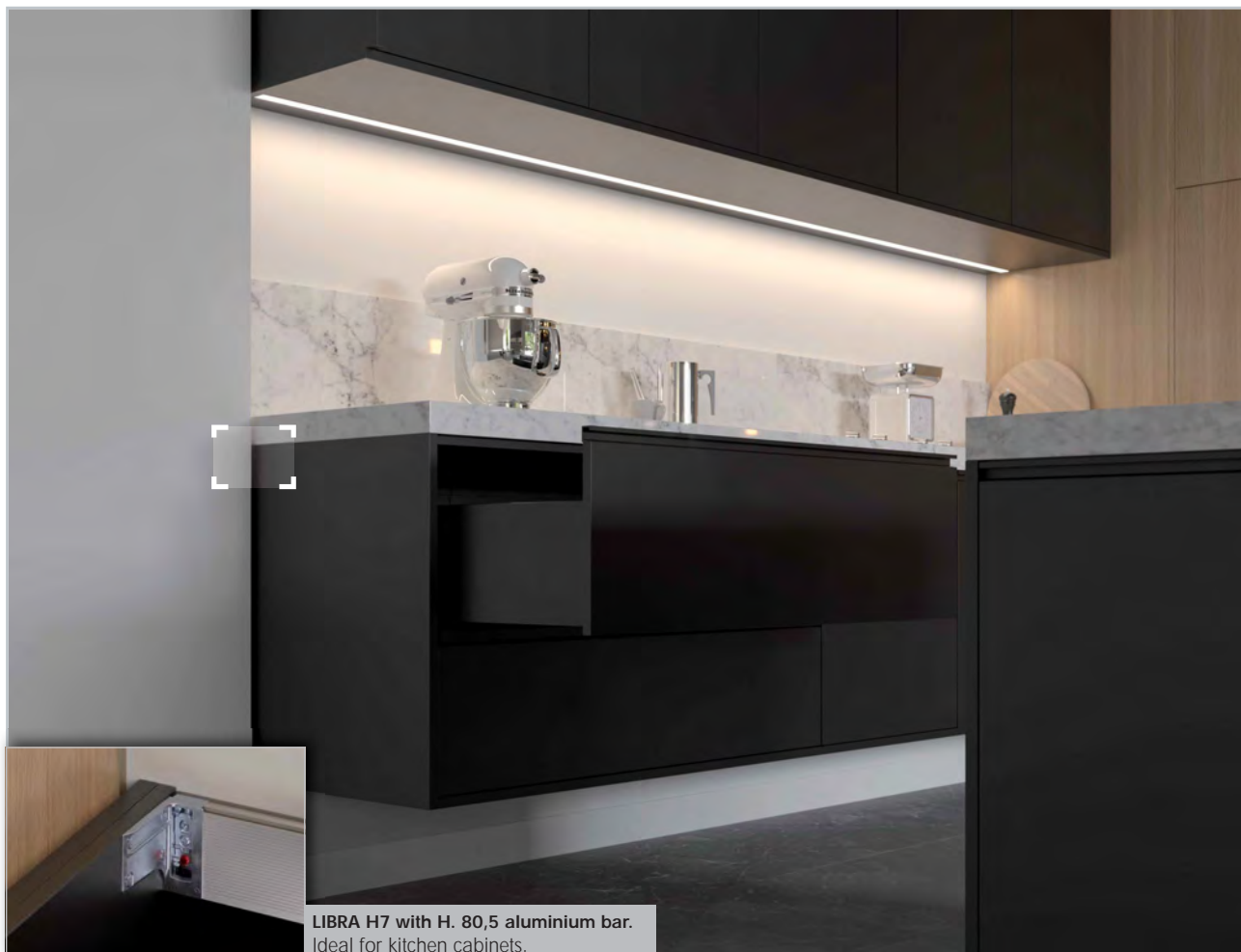

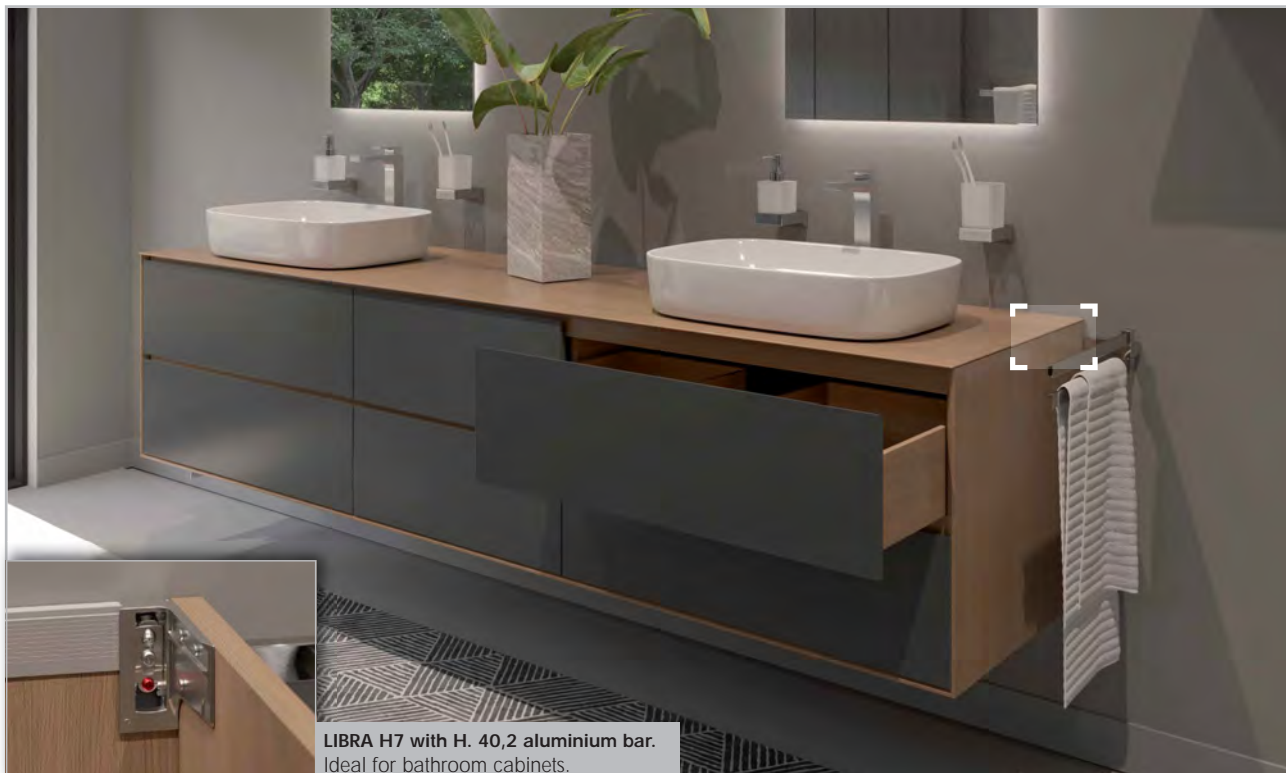

LIBRA H7 DOWEL FIXING WITH "PEG JOINT" FOR ALUMINIUM BAR



PATENTED

ASSEMBLING WITH OPTIONAL ALUMINIUM BAR H. 40,2 MM OR H. 80,5 MM

H. 40,2 MM ALUMINIUM BAR

Optional pre-drilled pilot holes

recommended fixing
self-tapping pan head
screws $\varnothing 4,2 \times 45$ mm

H. 80,5 MM ALUMINIUM BAR

Optional pre-drilled pilot holes

Optional wood dowel $\varnothing 8 \times 30$ mm

APPLICATION TO THE SUSPENDED BASE CABINET

Optional wood dowel $\varnothing 8 \times 30$ mm

recommended fixing 3 pan head
wood screws $\varnothing 3,5 \times 16$ mm

Optional back
panel 4-8 mm

Optional back
panel 4 mm

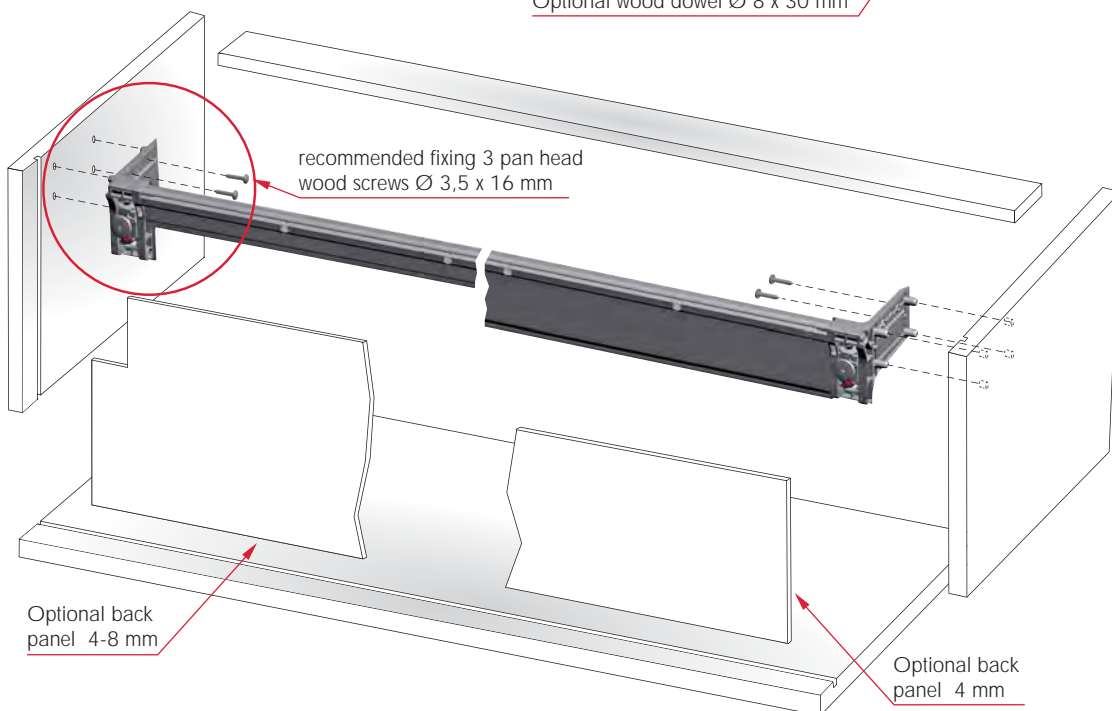
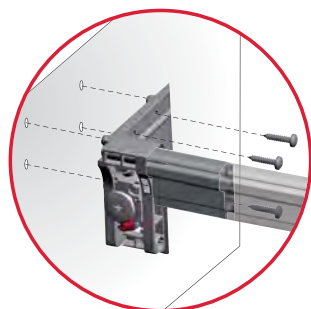

INSTALLATION ON THE WALL

- For details refer to "LIBRA WALL PLATES: LIBRA WP5"

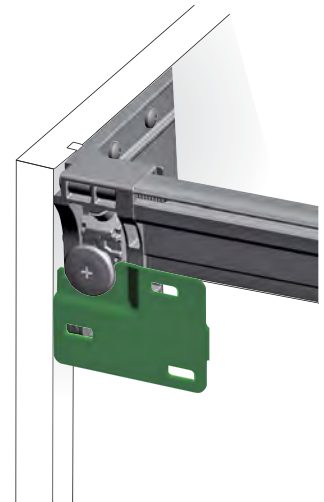
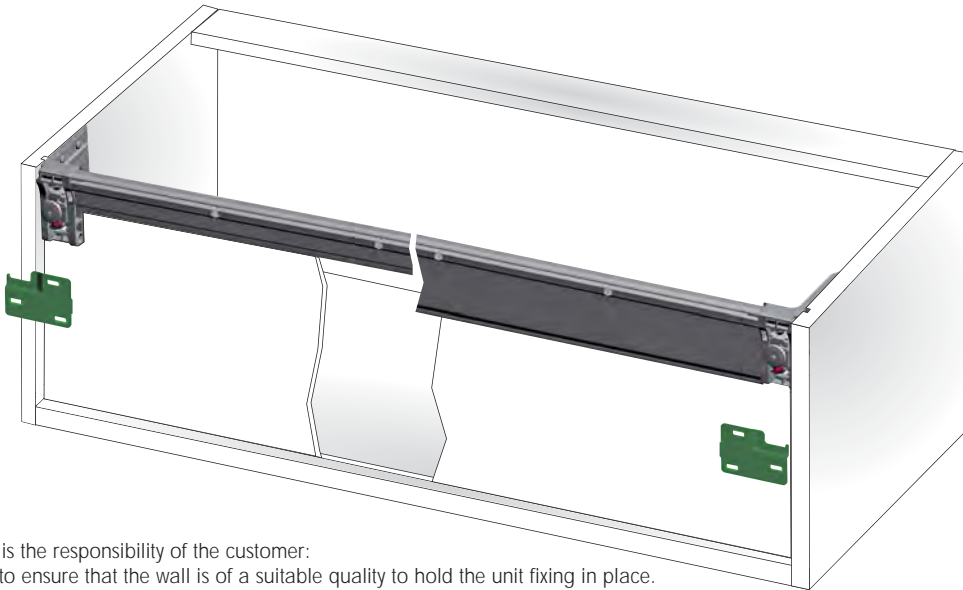

It is the responsibility of the customer:

- to ensure that the wall is of a suitable quality to hold the unit fixing in place.
- to use the proper hardware fittings according to the construction of the wall.

For more specific information, please refer to the WARNINGS section at the end of the catalogue.

ADJUSTMENTS (STEP 1)

1
VERTICAL ADJUSTMENT
13 mm

2
IN-DEPTH ADJUSTMENT
12 mm

3
ANTI-TURNOVER LOCKING
Stop screwing the red bolt when
it touches the wall plate

Slot for cross
PZ2 screwdriver

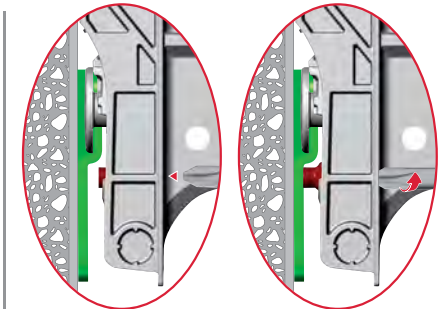
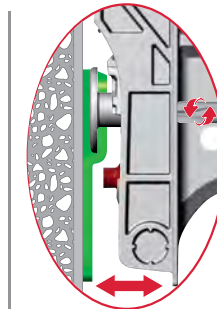
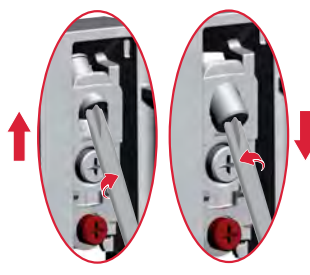
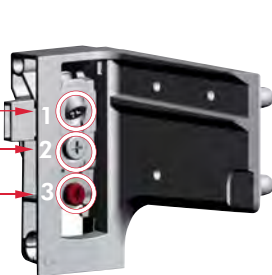
**EXTRA HANGING POINTS (STEP 2)**

The pre-drilled pilot holes ease the drilling operations on the wall.
Extra hanging points reduce the loading stress on the left/right wall plates.

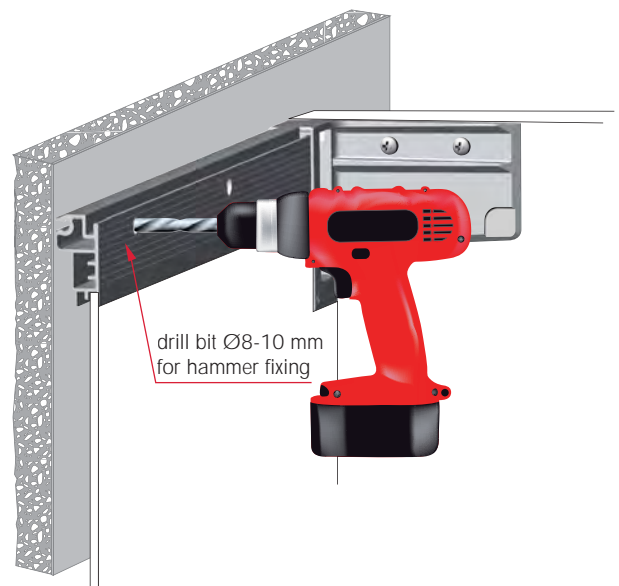
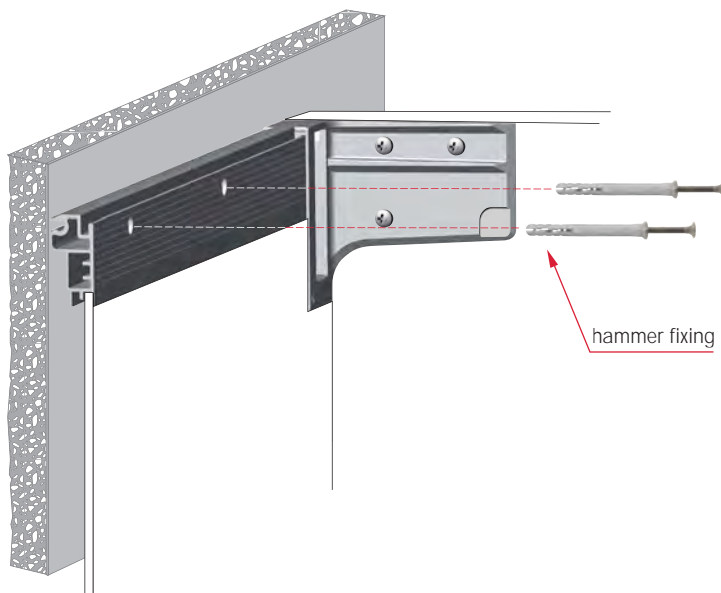



SIDE PANEL 15 MIN

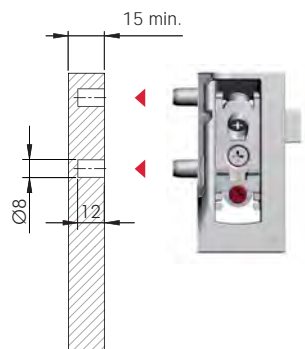

DRILLING PLAN WITHOUT BACK PANEL

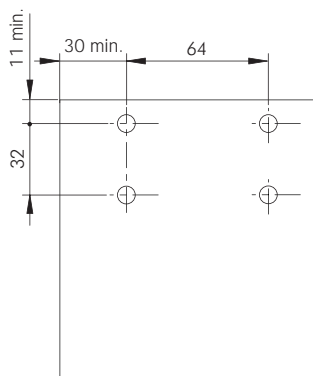

DRILLING PLAN WITH BACK PANEL WOOD THICKNESS 4 MM

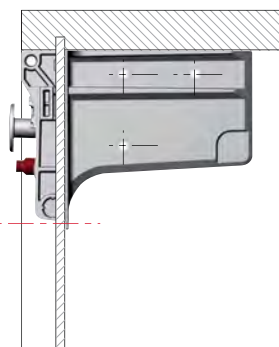
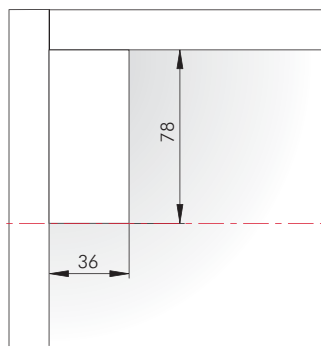
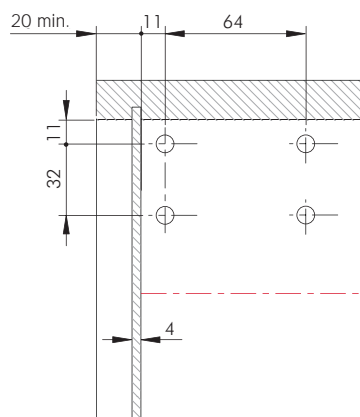

DRILLING PLAN WITH BACK PANEL WOOD THICKNESS 4 MM AND H. 40,2 MM ALUMINIUM BAR

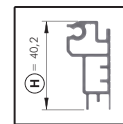
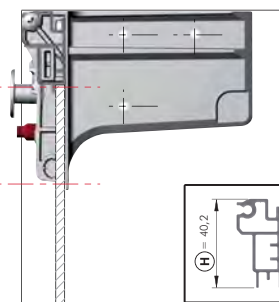
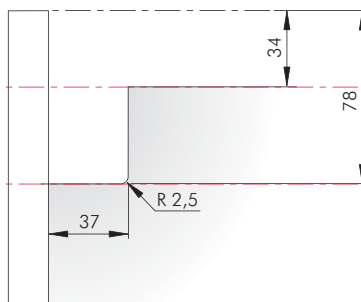
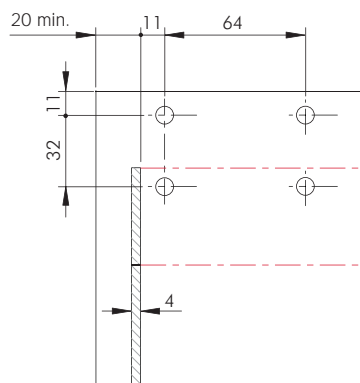

DRILLING PLAN WITH BACK PANEL WOOD THICKNESS 8 MM AND H. 40,2 MM ALUMINIUM BAR

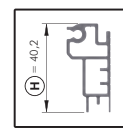
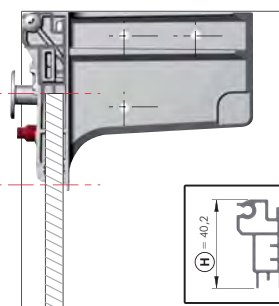
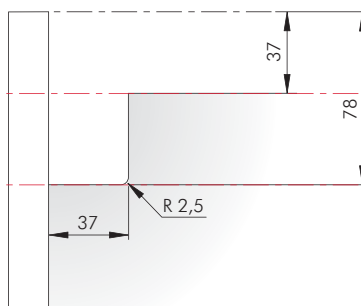
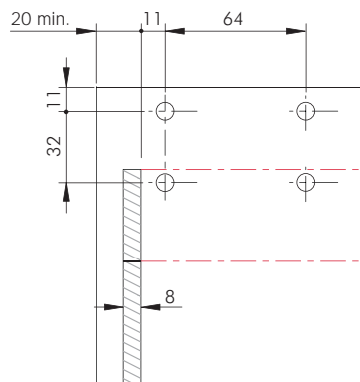

DRILLING PLAN WITH BACK PANEL WOOD THICKNESS 4 MM AND H. 80,5 MM ALUMINIUM BAR

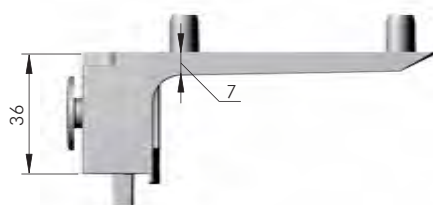
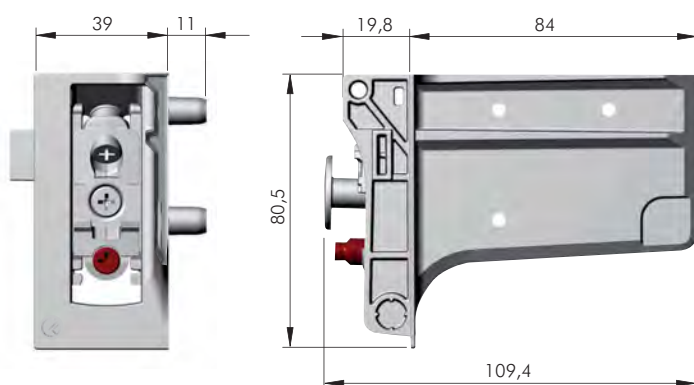
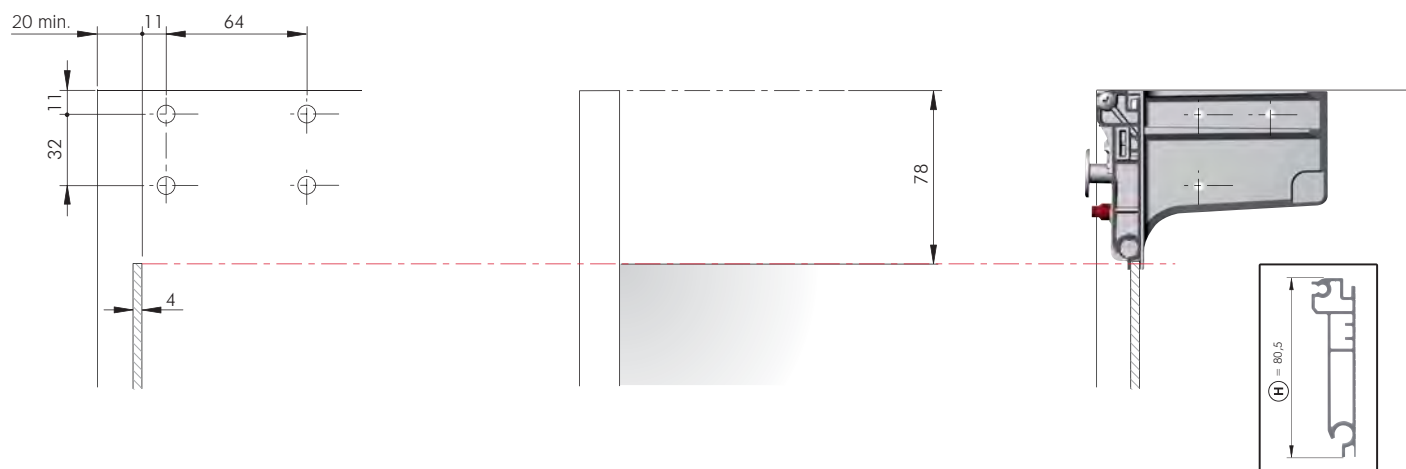

ZA

ST

 = 50 pcs.

63422200ZN



R

63422210ZN

L

NOTE: for technical details about wall plates please refer to the related sections "LIBRA WALL PLATES" on page 12.64.